

Mounting Instructions

Montageanweisung
 Instructions de montage
 Instrucciones de montaje
 Istruzioni di montaggio
 Montagehandleiding
 Montážní návod

Instrukcja montażu
 Instrução de Montagem
 Monteringsanvisning
 Monteringsanvisning
 Szerelési útmutató
 Asennusohje

Monteringsanvisning
 Руководство по монтажу
 Montaj Talimatı
 Οδηγίες μονταρίσματος

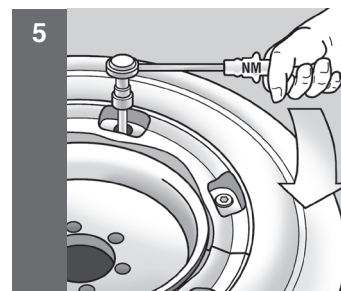
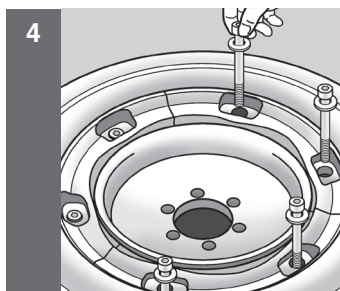
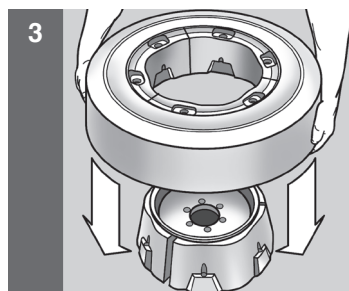
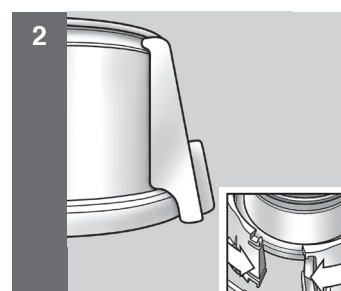
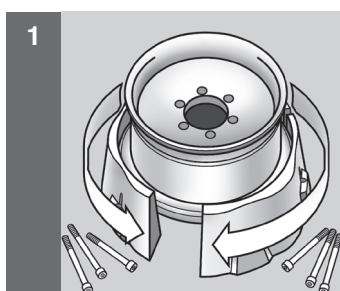
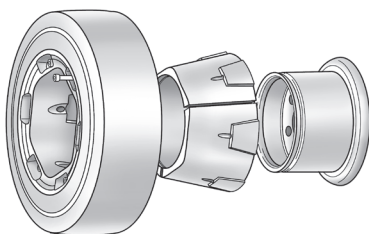

The bolts are to be tightened to the specified torque with an adjustable torque wrench (refer to table). Proceed crosswise in tightening the bolts. Retighten the bolts to the specified torque after the vehicle has been in operation for fifty (50) hours.

Tire size	Rim	Type of bolt mm	Strength	Torque Nm	Corrosion protection
5.00-8	3.00 D-8	M 8 x 75	10.9	25	Dacromet
125/75-8	3.00 D-8	M 8 x 75	10.9	25	Dacromet
150/75-8	4.33 R-8	M 10 x 110	8.8	49	electro-galvanized
180/70-8	4.33 R-8	M 10 x 110	8.8	49	electro-galvanized
6.00-9	4.00 E-9	M 10 x 100	8.8	49	electro-galvanized
200/75-9	6.00 E-9	M 12 x 145	8.8	85	electro-galvanized
200/50-10	6.50 F-10	M 12 x 160	8.8	85	electro-galvanized
225/75-10	6.50 F-10	M 12 x 160	8.8	85	electro-galvanized
6.50-10	5.00 F-10	M 12 x 125	8.8	85	electro-galvanized
180/60-10	5.00 F-10	M 12 x 125	8.8	85	electro-galvanized
7.00-12	5.00 S-12	M 12 x 125	8.8	85	electro-galvanized
250/60-12	8.00 G-12	M 12 x 200	8.8	85	electro-galvanized
250/75-12	8.00 G-12	M 12 x 200	8.8	85	electro-galvanized

Replacement screws available from Continental.

Mounting Instruction guides available in 17 languages at www.cseasy.de

ATTENTION: Safety and Warning Information found within Instruction guides.

